

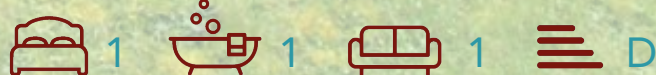

## Oliver Close

Rushden, Northants, NN10 0EL

**£92,500**



# Oliver Close

Rushden, Northants, NN10 0EL



## Description

**\*VIDEO TOUR AVAILABLE\*** Prime Choice are delighted to offer this well presented, 1 bedroom apartment located in Rushden. Recently refurbished, the property comprises a lounge, kitchen, bathroom, loft space and a double bedroom. Additional benefits include double glazing, recently fitted and updated electric heating and allocated parking.

Need more information? For FAQs, information about council tax and local schools, area guides and to join our mailing list, visit our website.

- New To The Market
- UPVC Double Glazing
- Loft Space
- Allocated Parking
- Video Tour Available
- Town Centre Location
- Electric Heating
- Recently Refurbished
- Easy Access To Rushden Lakes And Surrounding Areas





## Floor Plan

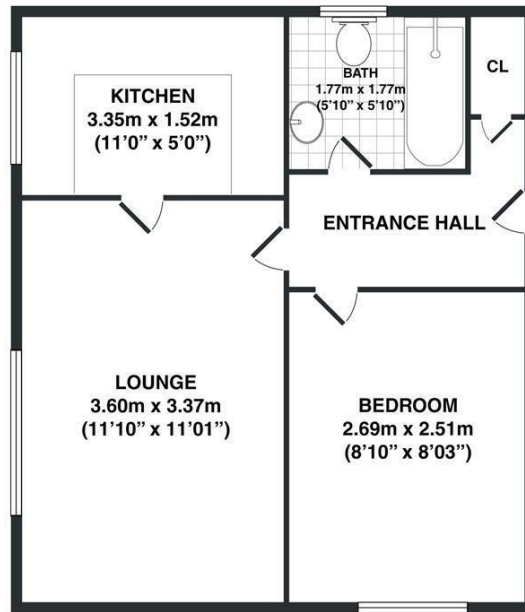

**Total area : approx. 27.1 sq. meters (291.7 sq. feet)**

This floor plan is for illustrative purposes and layout guidance only. It is not drawn to scale. Dimensions should not be used for carpet or flooring sizes and are not intended to form part of any contract.

## Area Map

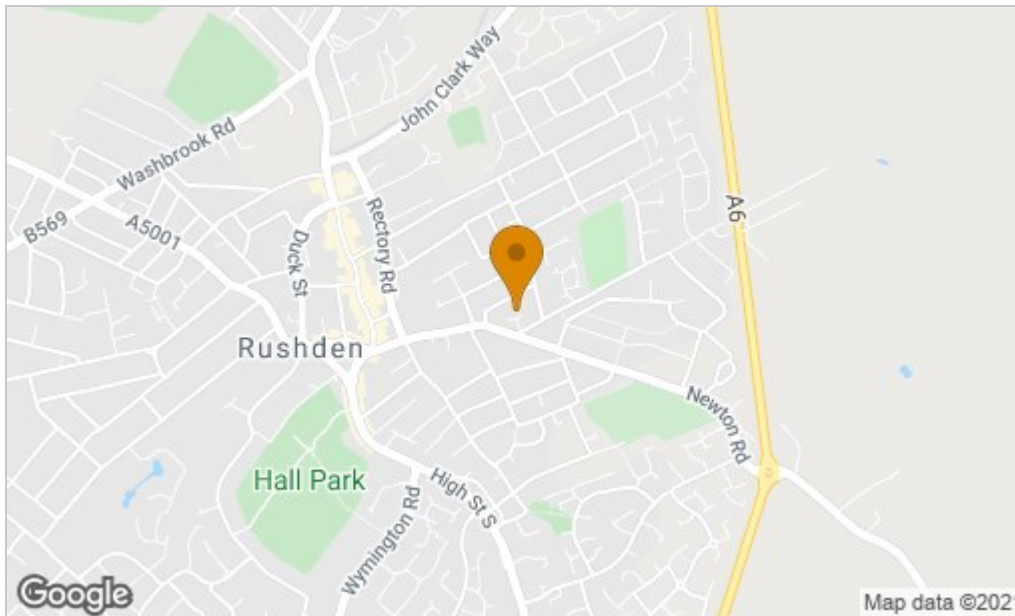

## Energy Efficiency Graph

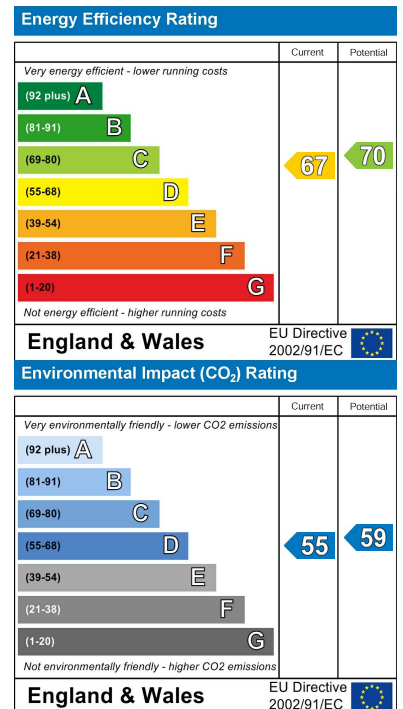

## Viewing

Please contact our Rushden Office on 01933 316 131 if you wish to arrange a viewing appointment for this property or require further information.

These particulars, whilst believed to be accurate are set out as a general outline only for guidance and do not constitute any part of an offer or contract. Intending purchasers should not rely on them as statements of representation of fact, but must satisfy themselves by inspection or otherwise as to their accuracy. No person in this firm's employment has the authority to make or give any representation or warranty in respect of the property.

123 -125 High Street, Rushden, Northamptonshire, NN10 0NZ  
 Tel: 01933 316 131 Email: info.rushden@primechoiceproperties.co.uk  
[www.primechoiceproperties.co.uk](http://www.primechoiceproperties.co.uk)

arla | propertymark

PROTECTED

naea | propertymark

PROTECTED